

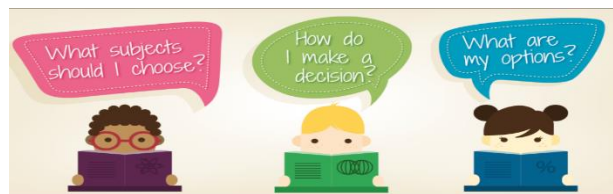

GCSE OPTIONS

YEAR 10 BOOKLET 2024



Name:

Class:

Subject options sheets will be available from Wednesday 17th January 2024.

Please keep up-to-date with GCSE Options information on Carrickfergus Academy Facebook Page, SIMS ParentApp & the School Website.

Contents

❖ Advice	3
❖ Art & Design	4
❖ Business & Communication Systems	5
❖ Child Development	6
❖ English Literature	7
❖ Further Mathematics	8
❖ Geography	9
❖ Government & Politics	10
❖ Health & Social Care	11
❖ History	12
❖ Home Economics	13/14
❖ Horticulture	15
❖ ICT	16
❖ Media Studies	17
❖ Music	18
❖ Occupational Studies (Hair & Business)	19
❖ PE & Sport	20
❖ Religious Education	21
❖ Science: Double Award	22
❖ Spanish	23
❖ Technology & Design	24/25
❖ Travel & Tourism	26
❖ Thinking ahead.....	27
❖ Subject leader contact details	28



Remember to keep an open mind with your future career hopes as you may change your mind in the light of fresh ideas or new developments.

SO, WHAT IS IMPORTANT?

Choose subjects that
SUIT YOU

And YOUR ABILITIES.

In doing so consider:

i. the subjects you **LIKE**

i.e. subjects where you enjoy the type of work and the classroom activities.

ii the subjects you are **GOOD AT**

i.e. where you feel confident about your progress and where you have gained good grades in tests, projects and/or examinations.

iii the subjects which have been **RECOMMENDED**

e.g. a teacher has made a point of saying to you that you have potential in their subject.

a relative has advised you to take a subject because they believe it to be important in today's / tomorrow's world.

iv the subjects which you may **NEED** i.e. subjects you think you will

Visit this website to support you and your parents / guardians <https://successatschool.org/>

GCSE ART AND DESIGN

At Carrickfergus Academy we offer the CCEA GCSE Art and Design specification. This is an exciting subject, helping students develop an understanding of how ideas and intentions can be communicated through a visual and tactile language. Students learn how to:

1. **Explore** ideas and observations through a wide range of media, materials and processes.
2. **Develop** their understanding of the creative and cultural industries.
3. **Experiment** in at least two of the following disciplines: Drawing and painting, Printmaking, Textiles, Ceramics, Digital media and 3D design.
4. **Create** final outcomes linking their work to the work of other artist/designers

Component 1 - (Coursework – 60%)

Part A - Exploratory Portfolio

Part B - Investigating the Creative and Cultural Industries

Component 2 - (Externally Set Assignment – 40%)

ESA - Students develop, explore and record ideas, working towards a personal outcome in response to an externally set theme.

<https://ccea.org.uk/key-stage-4/gcse/subjects/gcse-art-and-design-2017>

Content	Weighting	Assessment
Component 1 - Part A: Students develop, explore and record ideas based on a theme.	25%	Controlled Assessment Is both internally & externally moderated.
Component 1 - Part B: Investigating the Creative & Cultural Industries. Students present a personal outcome in response to a theme.	35%	
Component 2: Externally set assignment A stimulus paper is released in early Jan of Year 12. Minimum of 20 hrs prep in response to the theme and a final piece is completed in a 10 hour exam.	40%	Component 2 Externally Set Assignment is both internally and externally moderated.



art director
fashion designer
stylist
web designer
set design artist
painter
graphic designer
fashion illustrator
game designer
production artist
animator
creative director
character designer
illustrator
UX designer
gallery owner
sculptor
interior design

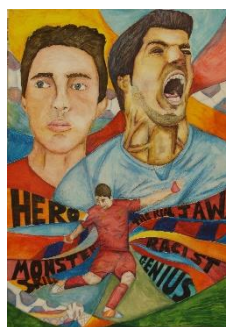

Who should consider choosing this subject?

- Pupils who enjoy Key Stage 3 Art and Design
- Pupils with an interest in working in a highly motivated environment
- Pupils who enjoy researching, taking their own photos and working from them.



“**CREATIVE** people
are **CURIOUS**, **flexible**,
PERSISTENT,
and **independent** with a
TREMENDOUS SPIRIT
of **adventure**
& a **love of play.**”
HENRI MATISSE

Topics Studied:

Practical

Fine Art

Fashion and
Textiles

3D Design and
Construction

Digital Art

Theory

Researching
processes,

materials and
tools of
practitioners,

Collecting
contextual
research



GCSE Business Communication Systems

Course Content

GCSE Business Communication Systems is offered to all Year 11 pupils, it is a very **applied** course which prepares students for the world of work and it incorporates Business along with ICT. No job in today's society is NOT a business!!!

This course is very relevant to today's business world. It helps students understand the changing role of ICT in business and economic activities. It also helps students understand the ways in which market environments are changing because of ICT, for example the rise of e-business.

This course helps students develop practical ICT and business skills that are useful in a diverse range of employment roles. It also prepares students for studying business and ICT at a more advanced level.

Topics Studied:

Practical

- Word processing
- Spreadsheets
- Databases
- Presentations
- E-Mail
- Web Design

Theory

- Business Ownership
- Stakeholder
- Communication
- Marketing
- Recruitment / Selection & Training

Who should consider choosing this subject?

- Pupils who have enjoyed KS3 Business & Enterprise
- Pupils who want to set up their own business in the future
- Pupils who enjoy working on computers
- Pupils who enjoy working in a highly motivating and changing environment

Content	Weighting	Assessment
Unit 1: Software Applications for Business	40%	Computer-based Examination - 1 hour 30 minutes
Unit 2: The Business Environment	35%	Written Examination - 1 hour
Unit 3: Developing Digital Solutions	25%	Controlled Assessment



Entrepreneur
Teacher
Marketing Manager
Public Relations
Criminologists
Hotel Management
Estate Agent
Retail
Recruitment Consultancy
Stock Broker
Business Manager
Retail Manager



Bank Manager
Accountant
Advertising
Marketing
TV/Film/Video Producer
Civil Service
Human Resource Manager
Quantity Surveyor
System Analyst
Market Researcher
Venture Capitalist
Practice Manager

GCSE Child Development



This is a qualification accredited and awarded by CCEA.

GCSE Child Development focuses on the development of

babies and small children (0–5 years). You will develop knowledge, understanding and skills, including practical skills, in these key areas:



- Pregnancy, childbirth and caring for a newborn baby
- The responsibilities involved in parenting and other family roles
- The social, physical, intellectual, communication and emotional development of small children, including their dietary, health and educational needs

Assessment

Content	Weighting	Assessment
Unit 1—Parenthood, Pregnancy and the newborn baby	30%	1 hour 15 mins written exam completed in the summer of Year 11
Unit 2—The development of the Child: 0-5 Years	30%	1 hour 15 mins written exam completed in the summer of Year 12
Unit 3—Investigation Task	40%	Controlled assessment Year 12

Who should consider choosing this subject?

- Those who have an interest in working with children
- Those who enjoyed Home Economics and Science at Key Stage Three.

Career opportunities

- **Midwife**
- **Nurse**
- **Nursery assistant**
- **Teacher**
- **Social worker**
- **Learning support assistant**



For more information visit:

<https://ccea.org.uk/key-stage-4/gcse/subjects/gcse-home-economics-child-development-2017>

English Literature



Course Content

GCSE English Literature is a qualification accredited and awarded by CCEA. The course **consists** of three units taken over two years. In Year 11, you will take two units. You will study one of Shakespeare's most famous tragedies, *Macbeth*, alongside one

How will my work be assessed?

You will complete one controlled assessment task on *The Study of Shakespeare*. You are allowed up to two hours to complete the task.

You will know what the question is before the task, so you will know exactly what you need to prepare. The test will be completed in your classroom and it will be marked by your teacher. You will be able to work alongside your classmates to plan your answers if you like and you can bring copies of the texts you have studied into the test! The test is worth 20% of the total GCSE mark.

You will also take one exam at the end of Year 11. This is a formal GCSE exam and will take place in the examinations hall. You will complete two tasks; one on the novel you have studied and one on an unseen text. This exam is worth 30% of your total GCSE mark.

Content	Weighting	Assessment
Unit 1: The Study of Prose	30%	Written examination 1 Hour 45 mins
Unit 2: The Study of Drama and Poetry	50%	Written examination 2 Hours
Unit 3: The Study of Shakespeare	20%	Controlled Assessment 2 Hours

hall. You will complete two tasks; one on the novel you have studied and one on an unseen text. This exam is worth 30% of your total GCSE mark.

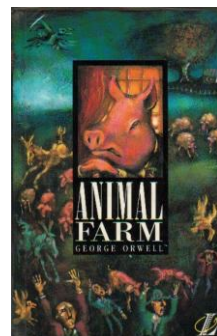

Why should I choose English Literature?

This course will provide you with a GCSE in English Literature and will be useful if you are interested in careers such as journalism, publishing, advertising or teaching.

There are other benefits too. Classes tend to be quite small, which means your teacher will be able to work closely with you to give you the help that you need to do well. The study of this subject also tends to improve your performance in English Language and in other essay-based subjects. We have also had excellent results and the majority of pupils who take GCSE English Literature go on to study it at A Level.

Pupils studying English Literature have also enjoyed cinema visits, trips to the theatre and interacting with professional actors in drama workshops.

I have never studied English Literature before. How do I know if it's the right choice for me?

If you enjoy your English classes, chances are you will enjoy this subject too. Why not chat to your English teacher? He / she will be able to advise you as to whether this course would be right for you. For further information about this course, go to:

www.rewardinglearning.org.uk/microsites/english_literature/revised_gcse/index.asp



Teaching
Writing
Publishing
Journalism
TV Presenting
Script Writing
Public Relations
Acting
Advertising
Event Management
Public Relations
Law
Broadcasting
Radio Production
Marketing
Office Administration

FURTHER MATHEMATICS

Specification at a glance

Content	Assessment
<ul style="list-style-type: none"> Unit 1: Pure Mathematics (50%) <i>Mandatory unit</i> 	<ul style="list-style-type: none"> External paper – 2 hours
<ul style="list-style-type: none"> Unit 2: Mechanics (25%) <i>Optional unit</i> 	<ul style="list-style-type: none"> External paper – 1 hour
<ul style="list-style-type: none"> Unit 3: Statistics (25%) <i>Optional unit</i> 	<ul style="list-style-type: none"> External paper – 1 hour
<ul style="list-style-type: none"> Unit 4: Discrete and Decision Mathematics (25%) <i>Optional unit</i> 	<ul style="list-style-type: none"> External paper – 1 hour

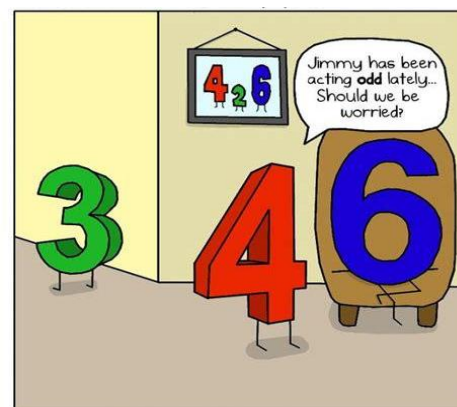

Benefits for students

A GCSE in Further Mathematics helps students to:-

- Use and apply standard techniques
- Reason, interpret and communicate mathematically
- Solve problems within mathematics and other contexts
- Gives an excellent stepping stone to A-Level Mathematics

For more information see <http://ccea.org.uk/mathematics/>

Unique features	Employability
<ul style="list-style-type: none"> New specification Comprises four units <ul style="list-style-type: none"> ➢ Pure Mathematics (<i>mandatory</i>) ➢ Mechanics (<i>optional</i>) ➢ Statistics (<i>optional</i>) ➢ Discrete & Decision Maths (<i>optional</i>) Centres choose two optional units More choice and broader range of mathematical topics Offers progression to GCE Maths/Further Maths and to other GCE subjects e.g. STEM, Geography, Economics, Business Studies 	<ul style="list-style-type: none"> Qualification is linked to GCSE Mathematics (higher tier) and GCE Mathematics Potential pathway into a range of careers, for example engineering, science, finance, statistics, computing, teaching Further Mathematics support Programme (MEI) Acknowledged by independent research

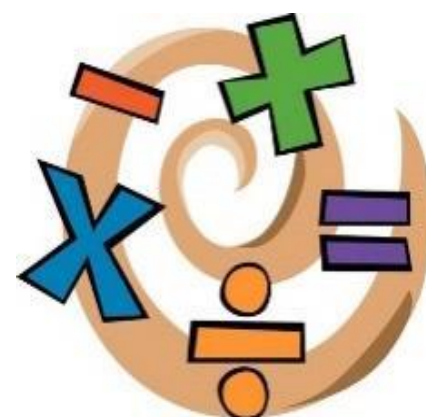

Investment banking
Financial adviser
Statistician

Pharmacy Sciences
Accountant
Research analyst

Computer scientist
Maths Teacher
Software developer

Engineer
Mathematician
Actuary



Geography



Course Content:

Geography allows the opportunity to develop communication, graphical, mapping, technological, interpersonal, problem solving, and entrepreneurial skills. **Geography** provides you with a clear overview of the world in the first part of the 21st Century. **Geography** intends to interest you by giving you an insight into future challenges through the study of current issues of local, national and global importance, and their future management. **Geography** gives you an appreciation of the significance of values and attitudes to the development and resolution of these issues. This gives you useful preparation for understanding the world in which you are going to live and work. **Geography** aims to raise your awareness of your responsibilities to other people, to the environment and to the sustainability of the planet.

Content	Content summary	Assessment	Weighing
Unit 1: Understanding our Natural World	Theme A: River Environments Theme B: Coastal Environments Theme C: Our Changing Weather and Climate Theme D: The Restless Earth	External Written Examination 1 hour 30 mins Taken at the end of Year 11	40%
Unit 2: Living in our World	Theme A: Population and Migration Theme B: Changing Urban Areas Theme C: Contrasts in World development Theme D: Managing our Environment	External Written Examination 1 hour 30 mins Taken at the end of Year 12	40%
Unit 3: Fieldwork	Students base their answers on their knowledge and experience of fieldwork This normally is a River Investigation and a small charge is asked to cover transport costs.	External Written Examination 1 hour Taken at the end of Year 12	20%

For more information visit: https://www.rewardinglearning.org.uk/microsites/geography/revised_gcse/index.asp

If you are good at Geography or enjoy the subject you should seriously consider taking it as one of your GCSE option choices. After all you have already been studying it for a number of years. You know what it is about!

CAREER OPPORTUNITIES



- Cartographer
- GIS applications
- Property Developer
- Urban Planner
- Tourist Information Officer
- Travel Agent
- Foreign/Travel Correspondent
- Geography Teacher
- Market Researcher
- Airline Flight Attendant
- Housing and Social Welfare Officer
- Conservation Officer

- Engineer
- Weather Forecaster
- Pilot
- Charter Surveyor
- Land and Water Management
- Environmental Health Officer
- Archaeologist
- Ecologist
- Careers in Agriculture/Horticulture
- Development Worker
- Air Traffic Controller
- Landscape Architect

GCSE GOVERNMENT and POLITICS

What's the most interesting thing in the world?



CCEA's GCSE in Government and Politics helps you understand who has power and authority and what our own roles are in our own countries political systems. This course provides solid preparation for those learners wishing to progress to AS and A Level in History and Government and Politics qualifications.

Content Overview	Weighting	Assessment
Unit 1 – Democracy in Action Decision Making, Elections, Political Parties, Role of the Media, Pressure Groups and Demonstrations	50%	Written exam 1 hour 30 minutes Year 11
Unit 2 – International Politics in Action Global issues, International Terrorism, European Union and Brexit, Conflict and the role of the UN Security Council, NATO and the UK, Peace Process in Northern Ireland, Migration	50%	Written exam 1 hour 30 minutes Year 12



This specification has no separate tiers of entry.

Extra information available at <https://ccea.org.uk/key-stage-4/gcse/subjects/gcse-government-and-politics-2017>

BUT WILL IT BE ANY USE TO ME WHEN I'M OLDER?

Studying politics may lead to a wide variety of career paths and becoming a career politician is just one option. Politics could be a great advantage in the business world as some companies want employees who have a global outlook and an awareness of how business is dependent on political issues. Students could go on to work in many roles including the following:



Civil Service
Radio and Television
Teaching
Law
Social and Probation services
Archaeology
Journalism

Research Machines plc.
Computing
Legal Executive
Policing
Barrister
Accountant
PR Officer

Careers in the Diplomatic Service.
Educational Psychologist
Media and Communications manager
Policing
Counter Terrorism

Health & Social Care

The GCSE Health and Social Care course gives you opportunities to learn about **human development** and investigate how factors, such as smoking, pollution, income or chronic illness, affect **health and well-being**.

You also learn about how **relationships** and **major life changes**, such as birth of a sibling, starting college, university or work, affect health and well-being. You also investigate the **sources of support** for individuals coping with life changes.

You develop understanding of the **world of work** in the health, social care and early years sectors by investigating how the needs of different service user groups are met. You also learn about a range of job roles in these sectors and discover how practitioners apply the **values of care**.

Subject Coordinator:

Miss C Acheson

Level: GCSE

Exam board: CCEA

Who is this subject for?

- Students considering a **career** in health, social care or early years
- Students considering **studying A-level** Health & Social Care
- Students who enjoy **project work** and working independently



Assessment



Unit:	Areas of Study	Assessment Description	Weighting
1: Year 11 Personal Development, Health & Well-Being	<ul style="list-style-type: none"> • human development • factors affecting health & well-being • relationships • self-concept • life changes and sources of support 	Examination (1 hour 30 minutes)	50%
2: Year 12 Working in the Health, Social Care and Early Years Sectors	<ul style="list-style-type: none"> • service users' needs • health and social care services • early years services • job in health and social care • the values of care • safeguarding 	Controlled assessment	50%

Careers

- Social Work
- Nursing
- Teaching
- Carer
- Child care
- Research work
- Nursing
- Nutrition / dietetics
- Occupational therapy

Any Questions?

Scan here...



Progression Opportunities:

- Level 3 **vocational qualifications** at a range of colleges
- **Academic qualifications** such as single or double award A-level Health & Social Care in Carrickfergus Academy
- **Employment** in the Health & Social Care sector, in due course, such as junior roles, or as an apprentice.

GCSE History

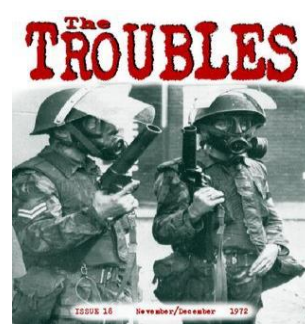

This specification provides you with the opportunity to explore key events that have helped shape the world we have today. You will learn and evaluate systems of government, cultures and societies. The specification prepares you for a range of careers and allows them to develop skills that are transferable and highly valued by employers. This specification has no separate tiers of entry.



Extra information available at www.ccea.org.uk/history/

Content	Weighting	Assessment
Unit 1 Life in Nazi Germany 1933-1945 Northern Ireland and it's Neighbours, 1965-1998	60%	Written exam 1-hour 45 minutes Year 11
Unit 2 International Relations 1945-2000	40%	Written Exam 1-hour 15minutes Year 12

HAVE YOU ENJOYED HISTORY IN JUNIOR SCHOOL? DO YOU WANT TO KNOW WHAT NAZI GERMANY WAS REALLY LIKE? ARE YOU INTERESTED IN THE TROUBLES IN NORTHERN IRELAND? DO YOU WANT TO KNOW WHY 9/11 HAPPENED? THEN PICK GCSE HISTORY!!



Civil Service
Radio and Television
Teaching
Law
Social and Probation services
Archaeology
Journalism
Psychology

Research Machines plc.
Computing
Archivist
Legal Executive
Policing
MUSEUM Curator / Keeper
Barrister

Tour Guide
Town Planner
Antiques Dealer
Professional Historian / University Lecturer
Careers in the Diplomatic Service.

Home Economics

As a department we will be offering two areas of study, of which you will be able to study one over the 2 year period. The area we select for you will enable us to ensure we meet all of your strengths so you can achieve your potential by the end of Yr11 and Yr12. Talk to your teacher to see what class they feel would suit you best. The 2 main subject areas are :-

- GCSE Hospitality
- OCN Diet Food and Hospitality

GCSE Hospitality

Studying Hospitality will introduce you to the diverse and global hospitality industry and the skills required for working in it. Through theory and practical work-related tasks, the specification will help you to develop the knowledge, understanding and skills that can prepare you for further study and/or employment.

Assessment

Content	Weighting	Assessment
Unit 1: The Hospitality Industry	25%	External written examination 1 Hour
Unit 2: Hospitality and the Customer	25%	External written examination 1 Hour
Unit 3: Food and Beverage Preparation and Service	50%	Controlled Assessment Students produce a portfolio of three tasks (30%) and contribute to planning and carrying out an event or function (20%)

For further information:

<https://www.rewardinglearning.org.uk/microsites/hospitality/>



Careers

Caterer
Event management
Conference and Banqueting Manager
Customer service
Chef
Food Technician
Bar Manager
Restaurant Manager
Hotel receptionist

Topics Studied:

Theory

- ❖ Safe food handling in hospitality outlets
- ❖ Communication
- ❖ Marketing and promotions
- ❖ Customer care standards and procedures
- ❖ Products and services
- ❖ Customers in hospitality
- ❖ Career opportunities in hospitality
- ❖ Diet and health in the hospitality industry
- ❖ Health and safety at work
- ❖ First aid

Practical

- ❖ Selecting, storing, preparing, cooking and serving food
- ❖ Food preparation roles
- ❖ Planning an event or function
- ❖ Cost and portion control
- ❖ Food preparation and cooking skills

E.g. Knife skills, pastry making, bread making, sauce and dressings, cake making.



Additional costs to study this subject:

Students will be asked to make a payment to contribute towards the ingredients at the start of Year 11 and Year 12.

OCN – Diet, Food & Hospitality

After successfully completing this vocational subject you will achieve an equivalent to a grade B at GCSE.

We will cover topics that will prepare you for employment in the hospitality industry and consider how consumers should make healthy diet choices for example:

- Practical cooking skills
- Customer service
- Food and nutrition
- Safety and hygiene



Assessment

- This subject is assessed 100% by portfolio work. That means you do not have to sit an exam.
- You will have to complete 5 portfolios over the 2 year course
- Some of these will include food practical assessments.

Who should consider this subject?

Someone who:

- Enjoys cooking and has good practical skills
- Enjoys Home Economics
- Has an interest in the hospitality sector
- Wants to learn more about how we can make healthy food choices.

Careers

- Chef
- Waiting staff
- Working in a hotel



“The Food and Drink industry is Northern largest manufacturer” (Invest NI)

Irelands

Additional costs to study this subject:

Students will be asked to make a payment to contribute towards the ingredients at the start of Year 11 and Year 12.



Horticulture



OCN Level 2 Certificate in Vocational Skills gives us an exciting opportunity to take advantage of the Horticulture units in this OCN course. This is an excellent opportunity to discover the joy of garden horticulture, paying particular attention to the idea of 'plot to plate' - essentially growing your own fruit, vegetables and herbs. This is an interesting and challenging subject mixing classroom based learning with getting your hands dirty planting and growing crops. The course leads to the equivalent of GCSE as per the National Qualifications Framework (NQF). The certificate is taught as a series of units which are assessed internally. **There is no final examination.**

Assessment

Content	Weighting	Assessment
Exploring Ecology and Conservation	20%	Practical assessments and written portfolio Year 11
Health and Safety in a Working Environment	20%	Practical assessments and written portfolio Year 11
Skills for Plant Propagation	20%	Practical assessments and written portfolio Year 11
Skills for Garden Horticulture	20%	Practical assessments and written portfolio Year 12
Skills for Herb Cultivation	20%	Practical assessments and written portfolio Year 12

Topics Studied include:

- Plant structure and function
- Plant growth
- Plant physiology
- Ecology and Conservation
- Ground preparation
- Planting woody and herbaceous plants
- Maintaining plant health
- Health and Safety in the working environment

Who should consider choosing this subject?

You should choose this course if you enjoy:

- ✓ Key stage 3 plant science topics
- ✓ You have an interest in gardening
- ✓ You have got 'green fingers'
- ✓ You enjoy working outdoors

More info@

<https://www.ocnni.org.uk/umbraco/Surface/Qualification/GetQualificationGuide?qubald=127140>

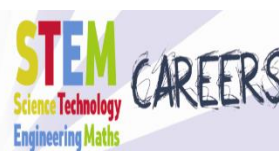

Good career opportunities are available in:

- garden design
- contracting
- local authorities
- sports facilities
- ancillary industry
- retail garden centres





ICT (Pearson BTEC - Level 2)

(Equivalent to 2 GCSEs)

Course Content

BTEC ICT will allow you to develop both knowledge and practical skills in ICT. It evolves from what you have already learnt in Key Stage 3 ICT, and helps you develop a deeper understanding of the more technical skills in various software applications. You will learn real-world skills that you can reuse in most careers, putting you ahead of the competition for jobs.

In addition, you will learn ICT theory knowledge, covering a wide-range of topics which will then be tested in two exams; one exam in Year 11 and the second exam in Year 12. Both exams will be completed on the computer, providing you with a unique, interactive setting to complete them.

Anyone choosing ICT at GCSE, is providing themselves with the perfect pathway into A-Level ICT should you choose this as option in the future.

Who should consider choosing this subject?

You should choose this course if you:

- ✓ Enjoy Key Stage 3 ICT.
- ✓ Enjoy learning creative ICT skills including using Photoshop.
- ✓ Enjoy learning technical ICT skills including using databases and spreadsheets.
- ✓ Like learning ICT theory topics.
- ✓ Are organised and can meet deadlines.

For further information visit:

<https://qualifications.pearson.com/en/qualifications/btec-firsts/information-and-creative-technology-2012-nqf.html>

Assessment

Units learnt	Weighting	Assessment
Unit 1 – The Online World	12.5%	External exam
Unit 2 – Technology Systems	12.5%	External exam
Unit 3 – A Digital Portfolio	12.5%	Internal coursework
Unit 4 – Creating Digital Animation	12.5%	Internal coursework
Unit 6 – Creating Digital Graphics	12.5%	Internal coursework
Unit 9 – Spreadsheet Development	12.5%	Internal coursework
Unit 10 – Database Development	25%	Internal coursework

Practical software used:

- ✓ Access (databases)
- ✓ Excel (spreadsheets)
- ✓ Photoshop (image editing)
- ✓ Animaker (animation)

Theory topics studied:

- ✓ Online services
- ✓ Online documents
- ✓ Online communication
- ✓ The internet
- ✓ Worldwide web
- ✓ Email
- ✓ Data exchange
- ✓ Data storage
- ✓ Data threats
- ✓ Computer and technology systems
- ✓ Applications and issues of technology systems
- ✓ Computer hardware devices
- ✓ Computer networking
- ✓ Data transfer
- ✓ Internal components of a computer
- ✓ Analogue and digital data
- ✓ Software
- ✓ Introduction to computer programming concepts
- ✓ Operating system applications

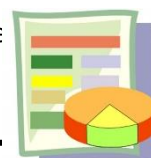

- ✓ Software Engineer
- ✓ Web Developer
- ✓ Web Editor
- ✓ Web Programmer
- ✓ Multimedia Animator
- ✓ ICT Technician
- ✓ Data Analyst
- ✓ Database Developer
- ✓ Multimedia Developer
- ✓ IT Technician
- ✓ Graphic Designer

Media Studies

Media Studies involves looking at the Media and its impact on our lives. If you are computer literate, good at Art, interested in films, television, magazines and radio, then this subject could be for you.



The Course



The two-year course consists of one coursework piece, requiring detailed written analysis which takes place over twelve weeks; and two, one and a half hour written exams. You study the examined texts throughout the two-year course.

Content	Weighting	Assessment
Unit 1: Exploring the Media	40%	Written examination 1 Hour 30 mins
Unit 2: Understanding Media Forms and Products	30%	Written examination 1 Hour 30 mins
Unit 3: Creating Media	30%	Controlled Assessment

Topics for Study

- Image Analysis
- Moving Image
- Computer gaming
- Film
- Music Videos
- Advertising
- Situation Comedies
- Inside the BBC
- TV Crime Drama



For further information about this course, go to:

www.edugas.co.uk/qualifications/media-studies/gcse/

Advertising executive

Computer Games Designer

Director

Film Producer

Journalist

Magazine Editor

Music Promoter

Photographer

TV Presenter

Animation

Computer aided design

Event Management

Fashion

Film and Television

Graphic design

Illustration

Interior design



GCSE MUSIC



Areas of Study

Western Classical Music 1650 – 1910;

Music for Film 1945 – present day;

Musical Traditions of Ireland

Popular Music 1980 – present day



COMPONENT	REQUIREMENT	DETAIL
Composing & Appraising 30%	Compose 2 pieces lasting 4–6 minutes in total.	One composition must be written in response to a pre-released stimulus provided by CCEA. The other composition will be free choice.
Performing & Appraising 35%	Perform by yourself and as part of a group. You may sing OR play.	You can choose your pieces – <u>it is preferable that you are having music lessons on your chosen instrument</u> There will be a short discussion with the examiner about your performance.
Listening & Appraising 35%	One Written/Listening paper lasting 1 hour 30 minutes.	The questions will be based on what you have learned over the 2 years. You will hear both familiar and unfamiliar music



Events Administration
Television Presenter
Radio Presenter
Stagehand
Roadie
Television producer
Recordings Agent
Artist Manager
Booking Agent

Sound Engineer
Music Sequencer
Music Producer
Sound Technician
Music Publisher
Events Administration

DJ
Arranger
Composer
Musician
Teacher
Orchestral Manager
Music Librarian
Orchestral Manager
Music Therapist

Occupational Studies

Hair & Business



Occupational Studies provides opportunities for pupils to learn for life and work. Learning will take place in the classroom, the ICT suite and in our specially equipped Hairdressing Salon. This hands-on approach is ideal for those who prefer to develop their skills in a more practical, occupational environment.

YEAR 11	YEAR 12
<i>Units starting Sep 22</i>	<i>Units starting Sep 2</i>
Business & Services Pathway	Design & Creativity Pathway
Shampooing & Conditioning Treatments 25% Portfolio & Practical Tasks	Creative Styling using Blow Drying Techniques 25% Portfolio & Practical Tasks
Customer Services 25% Portfolio & Practical Tasks	Website Design 25% Portfolio & Practical Tasks

Topics Studied:

- ❖ Client consultation
- ❖ Preparation of treatment areas
- ❖ Health & Safety
- ❖ Shampooing
- ❖ Blow drying techniques
- ❖ Customer service
- ❖ Web Design

For more information visit: https://www.rewardinglearning.org.uk/microsites/occupational_studies/
How will I be assessed?

Occupational Studies assessments requires you

- to recall knowledge of the unit content (theory)
- apply your knowledge in work environment scenarios showing you understand how to carry out treatments (practical assessments)
- analyse and evaluate your work saying what you can improve on

Who should pick it?

- Pupils with a career ambition to work within the hair and beauty industry
- Pupils who intend to apply for Hair and Beauty courses after year 12
- Pupils who display creative skills
- Pupils who enjoy working with others, talking to people and working as a team



Beauty therapist
Brow Specialist
Pedicurist
Spa manager
Counter assistant

Nail Technician
Holistic Therapist
Business Owner
Cruise ship therapist

Makeup artist
Spray tan artist
Massage Therapist

Lash Technician
Manicurist
Salon manager

Physical Education & Sport

The Physical Education and Sport option is aimed at those pupils who may be interested in a career within the sport industry and also towards those pupils who have a general interest in sport, nutrition and physical activity. The courses look at building different ways in which a person can lead a healthier, active lifestyle throughout their life. The course on offer is designed to be weighted more towards practical and coursework assessments and only 1 exam worth 25% of the overall grade.

What types of classes will you have in PE / Sport?

- Practical classes such as Badminton in the PE halls
- Practical classes in the fitness suite learning about training programmes
- Theory classes in the computer rooms to type up your coursework or practice for your online exam

<u>Course on offer</u>	<u>Weighting</u>	<u>Assessment</u>
<u>BTEC Level 2 First Award in Sport</u>		
<u>Unit 1:</u> Fitness for Sport and Exercise	<u>25%</u>	<u>Computerised test 1hr 15mins</u>
Unit 2: : Practical Sports Performance	<u>25%</u>	<u>Practical assessment & Written Portfolio</u>
Unit 3: Applying the Principles of Personal Training	<u>25%</u>	<u>Practical assessment & Written Portfolio</u>
Unit 6: Leading Sporting Activities	<u>25%</u>	<u>Practical assessment & Written Portfolio</u>

For more info on the course visit the course website:

BTEC PE Course <https://qualifications.pearson.com/en/qualifications/btec-firsts/sport-2012-nqf.html>

Who should consider picking PE

- Pupils who have an excellent participation record in PE and Games
- Pupils who play on school sports teams and/or outside club teams
- Pupils who achieve 70% or more in KS3 tracking tests
- Pupils who have a desire to follow a career path in Sport



Sports Coaching
Dietician
PE Teacher
Leisure Attendant
Physical Activity Instructor

Sports Development Officer
Physiotherapist
Fitness Instructor
Sport Scientist

Professional Athlete
Physiologist
Personal Trainer
Events Manager

Play badminton

Learn to score games

Learn how to design gym programmes

Learn how to fitness test & train

Evaluate your performance

(RE-THINK)?

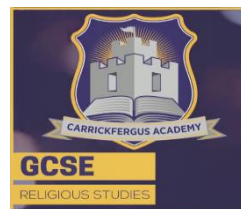

GCSE RELIGIOUS STUDIES

It's **Religious Studies** but not as you know it!

Religious Studies is perhaps one of the most relevant

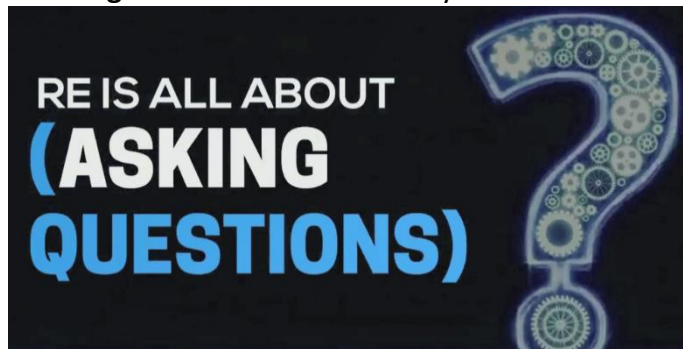

subjects to study at **GCSE** as we focus on many interesting **ethical** issues that affect society today such as relationships, marriage and divorce, same-sex marriage, gender, racism, prejudice and discrimination, abortion, capital punishment and modern warfare to name a few.

RS is more than just Bible readings but

seeks to apply what the Bible says to the situations in which we find ourselves in the

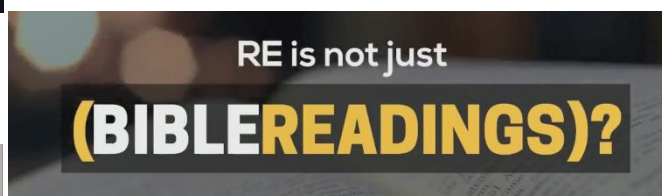

21st Century.

GCSE Religious Studies course encourages students to develop an enquiring, critical and reflective approach to studying which is relevant to a wide range of academic and vocational professions including teaching, social work, nursing, youth work, law. Students explore important questions about belief and respond to them personally. Students are encouraged to engage with both sides of the argument and then express their own views in a respectful manner. This helps to enhance their moral, cultural and spiritual development, helping them to contribute to society.



Alongside the ethical issues, we study the Gospel of Matthew which among other things helps to provide a biblical foundation for the ethics

component. This module is full of familiar stories and continues to be popular among students. You can see the full specification at http://ccea.org.uk/religious_studies/

Course Breakdown

MODULE 6	Weighting	Assessment	MODULE 4	Weighting	Assessment
An Introduction to Christian Ethics	50%	Written examination 1 ½ Hour	Christianity through a Study of the Gospel of Matthew	50%	Written examination 1 ½ Hour



GCSE DOUBLE AWARD SCIENCE



Course Content

GCSE double award science is an exciting subject that is made up of **Biology**, **Chemistry** and **Physics**; a bit of each is studied in year 11 and again in year 12. **Practical work** is very important and there are 18 Prescribed Practical investigations which are carried out over the 2 years, which can be tested by practical exams in Year 12. We want to **empower** young people to join an innovative and dynamic economy through Science!

➤ For more info please see the CCEA website:

<https://ccea.org.uk/key-stage-4/gcse/subjects/gcse-science-double-award-2017>

❖ Course Breakdown

Content	Weighting	Assessment
Year 11: Biology, Chemistry and Physics Unit 1	33%	3 GCSE module tests, November, February and May 1 hour each
Year 12: Biology, Chemistry and Physics Unit 2	42%	3 Written examinations in May/June 1 Hour 15 mins each
Year 12: Practical work over both years is tested. Booklet A is on hands-on practical exams and Booklet B is questions based on practical tasks carried out	25%	3 practical exams of 1 hour each in Year 12 and 3 written papers about practical tasks of 30 mins each after theory papers

Who should consider choosing this subject?

- Pupils who enjoy key stage 3 Science
- Pupils with an interest in achieving 2 GCSEs in Science
- Pupils who are interested in following a scientific or medical career path
- Pupils who enjoy practical and written science tasks
- Pupils who would consider further studies in science at A level
- Pupils who are motivated about learning more about how the world works



Engineering
Agriculture
Nursing
Midwifery
Physiotherapy
Occupational therapy
Food Science
Medicine
Most engineering/technology - based apprenticeships

Forensic Science
Pharmacy
Dentistry
Dietetics
Architecture
Veterinary Medicine
Electronics
Many military careers

Topics Studied:

- Cells and living processes
- Structures, Trends, Chemical Reactions
- Motion, Force, Energy, Radioactivity, Nuclear Fission and Fusion
- Body Systems,
- Genetics,
- Microorganisms and Health
- Waves, Light, Electricity, Magnetism, and Space
- Further Chemical Reactions,
- Rates, Calculations and Organic Chemistry



GCSE Spanish

Course content:

The GCSE Spanish course covers a wide variety of relevant topics, and through studying the course, pupils develop the four skills associated with language learning: Listening, Speaking, Reading, and Writing. Students will also develop a greater awareness of key grammar points, as well as being able to understand and express activities in the present, past, and future tenses. Candidates are entered at Foundation or Higher level.

Skill	Weighting	Assessment
Listening	25%	Written exam - 35 or 45 minutes (Foundation or Higher)
Speaking	25%	One speaking test - 7-9 or 10-12 minutes
Reading	25%	Written exam - 45 minutes or 1 hour
Writing	25%	Written exam - 1 hour 10 minutes or 1 hour 15 minutes

You might consider this subject if you enjoy the following:

- KS3 Spanish
- Developing your knowledge of the life & culture of other countries
- Developing your research, collaboration, & analytical skills



Topics studied:

- Identity & relationships with others
- Healthy living & lifestyle
- Education & work
- Free-time activities
- Customs, festivals & celebrations
- Celebrity culture
- Travel & tourism
- Media & technology
- The environment & where people live

For further details, please speak to your Spanish teacher.

Alternatively, look at the examination board's website: www.aqa.org.uk

There are no additional costs involved in studying this subject, but it is useful to have access to a Spanish dictionary.



Potential careers requiring or involving the use of a modern language - Spanish:

Teaching, translating, interpreting, law, finance and business, IT, gaming industry, engineering, civil service, diplomatic service, European Commission, journalism and broadcast media, transport and tourism, sport, music, language therapies.

It must be stressed that having a GCSE in another language is potentially beneficial to **any** career, and employers of all kinds view the general skills that are developed by language learners as being desirable in a wide variety of disciplines. Having knowledge of another language will also be of benefit to you as it will help to improve your literacy and interpersonal skills. Remember also that Spanish is one of the most widely spoken languages in the world, and it is rapidly becoming the second language of the United States of America.

It is also worth pointing out that some universities require all students to have studied at least one modern foreign language to GCSE level - this is regardless of the degree course for which they are applying.

TECHNOLOGY

SUITE OF SUBJECTS

Lots of **girls and boys** now choose Tech at GCSE –



As a department we will be offering two areas of study, of which you will be able to study one over the 2 year period. The area we select for you will enable us to ensure we meet all of your strengths so you can achieve your potential by the end of Yr11 and Yr12. The 2 main subject areas are –

- **GCSE PRODUCT DESIGN** (Academic/Non Vocational route which leads to A level study)
- **LEVEL 2 OCCUPATIONAL STUDIES** (Vocational route which will develop your skills and knowledge preparing you for an apprenticeship, employment, or further vocational study.)

GCSE PRODUCT DESIGN

Technology and Design is an ever changing subject and this year as you will see in class we are focus on **Design /Product Analysis through ACCESS FM** and **computer aided design** aspects in the subject. This develops your designing ability https://www.rewardinglearning.org.uk/microsites/technology/revised_gcse/index.asp

Year 11 and 12 are focused on the design and manufacture of products and together we will look at how the world of design and manufacturing operates in the real world today.

This Product Design subject offers you a real opportunity to develop your creative side.

So if you are someone who likes to **design/make & think about** the products around us, this is the subject for you!

Technology and Design is **50% coursework**. This allows your teacher to guide your progress over the 2 year course and to assist you with areas you may find difficult.

How is the course divided?

Year11 – UNITS - Practical skill development
(Mini project / CAD / CAM)

- Exam content **ONLY** 25%

Year12 – UNITS -

- Main project worth 50%.
- Exam part 2 **ONLY** 25%

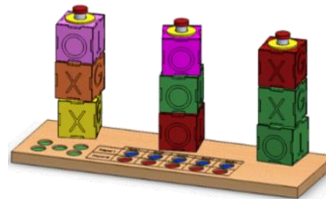

Pupils will be asked to make a one off payment of £20 in September of yr11

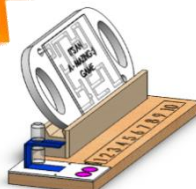

The department will be using the CAD machinery - **Laser cutter, Micro Router and 3d Printer** as a major part of our design and manufacturing throughout your main practical project.

Most of this course is practical through DESIGN and MANUFACTURE– 50%

When we go to make our Design Project you will have the **FREEDOM** to choose your **own** theme and design, you will get the chance to use all the tools and machinery within the department.

Take your first step with us at GCSE then perhaps we will see you at A-level



- Jewellery Designer
- Wood Carver
- Construction Technician
- Shop Fitter
- CAD technician
- Product designer

- Design Assistant
- Quality control
- Quantity surveyor
- Fashion Designer

- Technology and Design Teacher
- Craft Designer
- Primary Teacher
- Interior Designer
- Special Effects Designer
- Graphic Designer
- Set Designer
- Costume Designer

N
O
W

P
R
A
C
T
I
C
A
L

Y
R
11

TECHNOLOGY

Vocational route



LEVEL 2 Occupational Studies

This is a VOCATIONAL AREA which provides lots of practical experience in school and has proven very popular with the current Year 11 and Year 12. This is a **Level 2 qualification** which is equivalent to **2 GCSE'S**.

As a department we have focused on providing you with a wide arrange of units allowing you the opportunity for the hands-on experience of 4 individual skilled areas.

Throughout Year 11 and Year 12 you will complete 4 units each of which will be examined separately, (worth 1 point which will help when returning to school).

Visit the website for more info:

https://www.rewardinglearning.org.uk/microsites/occupational_studies/revised/specification/index.asp

The subject currently offers a range of 4 Units:

The course consists of 4 units ranging:

Construction 2 units = Bench joinery + Carpentry and Joinery

Pupils will be asked to make a one off payment of £20 in September of Yr11

Engineering and Services 2 units = Sheet Metal work + Electrical installation

UNIT - Carpentry and joinery



UNIT - Bench joinery

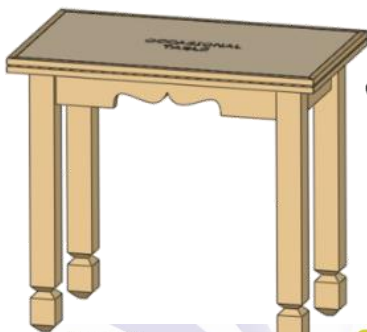

UNIT – sheet metal work

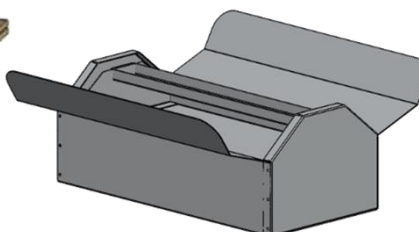

UNIT – Electrical installation

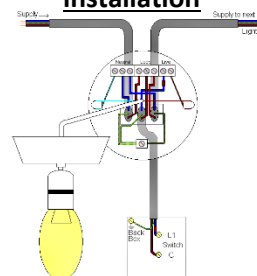

Joinery/Engineering – will open lots of avenues within STEM areas and the world of manufacturing

Teacher
Architectural technician
Quality control inspector
Surveyor
Workshop joiner
College Tutor
Kitchen manufacturing
Workshop joinery

Ryobi
Workshop joinery
NIE
NI WATER
NI WATER
BT Apprenticeship
Wrightbus
Business owner
Bombardier

Plumber
Joiner
Builder
Scaffolding erector
Business owner
Bombardier
Ventilation technician
Welder



BTEC TRAVEL AND TOURISM



EQUIVALENT TO 2 GCSEs

The BTEC in Travel and Tourism Level 2 course has been designed to inspire you to consider a career in the Travel and Tourism sector and to develop knowledge, understanding and skills in this area. The course opens up employment opportunities within a wide range of roles across the Travel and Tourism sector such as in travel

agencies, visitor attractions and accommodation as well as providing an opportunity for further study at GCE level.

HOW WILL YOU BE ASSESSED?

<u>Content</u>	<u>Weighting</u>	<u>Assessment</u>
<u>Year 11:</u> <u>Unit 1</u> <u>Unit 2</u> <u>Unit 4</u> <u>Unit 5</u>	<u>50%</u>	<u>Written Exam</u> <u>Written Portfolio</u> <u>Written Portfolio</u> <u>Written Portfolio</u>
<u>Year 12:</u> <u>Unit 6</u> <u>Unit 7</u> <u>Unit 8</u> <u>Unit 10</u>	<u>50%</u>	<u>Written Portfolio</u> <u>Written Exam</u> <u>Written Portfolio</u> <u>Written Portfolio</u>



Holiday Rep

Tourism Officer

Event Manager

Marketing Executive

Tour manager

Travel Agent

Hotel Manager

Cabin Crew

Topics Studied:

- The UK Travel and Tourism Sector
- UK Travel and Tourism Destinations
- International Travel and Tourism Destinations
- Travel and Tourism Business Environments
- Factors Affecting Worldwide Travel and Tourism
- The Travel and Tourism Customer Experience
- Organising a Travel and Tourism Study Visit

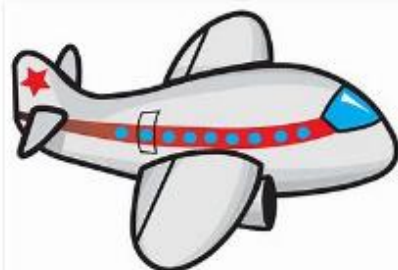

Thinking ahead.....

After GCSE you will have 3 possible career paths to follow. Consider these carefully and ensure you pick subjects that are going to allow you to follow the path that suits you! If you are not sure what that is, then pick subjects that will keep all your options open.

Study A Levels

Most schools use a points system to determine if a pupil can be considered for a place in sixth form. The Academy require pupils to have achieved a minimum of 6 GCSE points to include a minimum of 2 at A*-C grades (or equivalent) at GCSE.

The GCSE Points score will be determined as follows: -

(1) GCSE:

Grade A* = 4 points, Grade A = 3 points, Grade B = 2 points, Grade C* = 1.5 points, Grade C = 1 point

Number grades GCSE's using 9-1 scoring as follows

Number grades GCSE of 9/8 = 4 points, 7 = 3 points, 6 = 2 points, 5 = 1.5 points, 4 = 1 point

(2) Level 2 BTEC Subjects

Distinction = 3 points, Merit = 2 points, Pass = 1 point

(3) Prince's Trust pass will count as equivalent to 1 GCSE B Grade

The Principal will determine the points awarded for other non-GCSE Level 2 qualifications based on the Ofqual / NIEFQAN register.

Studying at a further education college eg NRC

Level 2 BTEC Diploma = 4 GCSEs at Grade D-G or above, or equivalent

Level 3 BTEC Diploma = 4 GCSEs at Grade C or above, or equivalent

Gaining employment

Most employers will ask for GCSE Maths and English as a minimum requirement for any job. On top of this they will ask for experience and skills that are required for the job. Vocational qualifications are a good way of gaining these skills whilst studying in Year 11 and 12.



*Please note that these grades and qualifications are based on entry requirements that are subject to change on an annual basis.

Subject Leaders.....

If you have any questions about a subject, email the subject leader:

Art	cthacker894@c2kni.net
Business	jevans597@c2kni.net
Child development	amcilwrath075@c2kni.net
English Literature	jluke306@c2kni.net
Further Maths	lfotheringham347@c2kni.net
Geography	rmacquarrie213@c2kni.net
Government & Politics	pmiddleton138@c2kni.net
Health & Social Care	cacheson055@c2kni.net
History	pmiddleton138@c2kni.net
Home Economics	amcilwrath075@c2kni.net
Horticulture	gedwards630@c2kni.net
ICT	colaughlin003@c2kni.net
Media Studies	jluke306@c2kni.net
Music	swalters821@c2kni.net
Occ Studies Hair & Business	mrenton877@c2kni.net
PE	sharrison755@c2kni.net
RE	abennett961@c2kni.net
Science	gedwards630@c2kni.net
Spanish	lhaddock487@c2kni.net
Technology & Design	dsimpson885@c2kni.net
Travel & Tourism	rmacquarrie213@c2kni.net